

Instruction

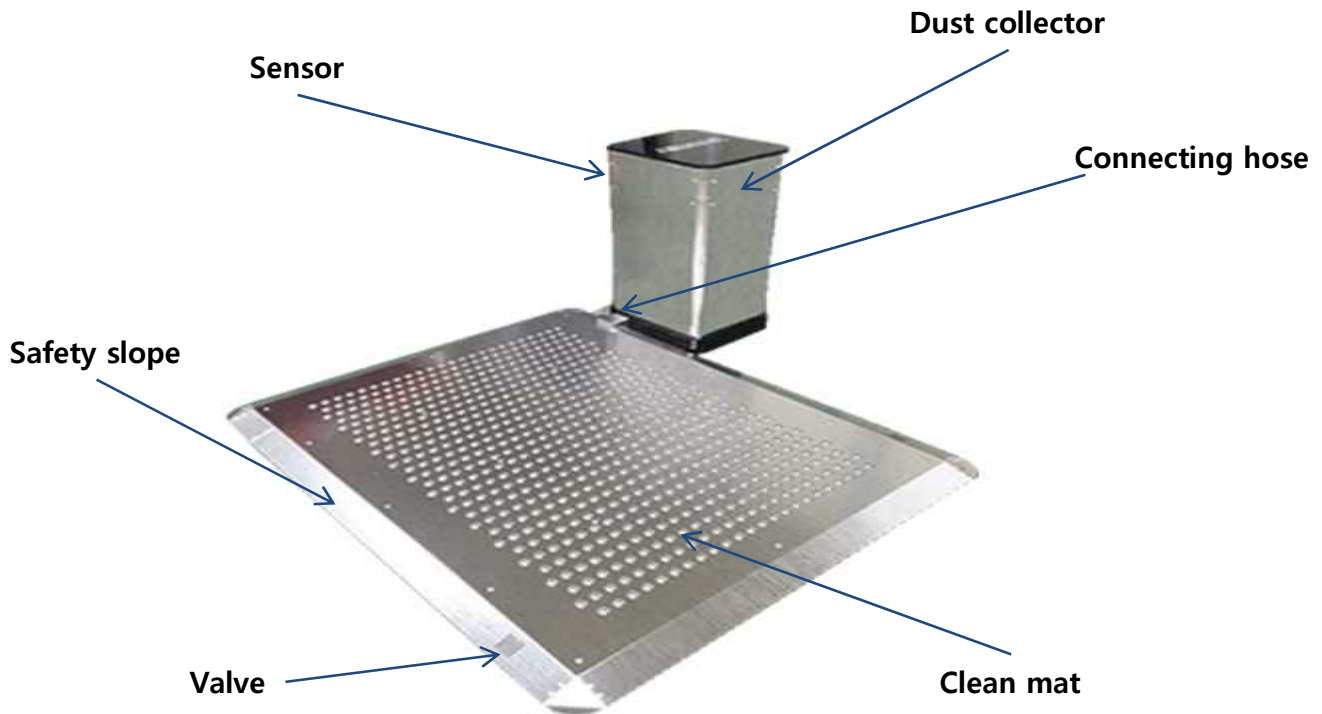

1. Names of all parts



Instructions for all parts

- **Dust collector** : It operate the motor and absorb the dust. There are dust bag collecting the dust and HEPA filter purifying air. Also you can use AIRMAX clean mat effectively because It can set operating timer
- **Sensor** : When approaching the mat, sensor recognize it and works. The length of sensor is flexible. There are 2 type of sensors(Pressure sensor and photo sensor)
- **Valve** : Absorbing surrounding air and purify it.
- **Connecting hose** : Connecting the dust collector and clean mat(suction mat) to boost the power of suction
- **Clean mat** : Treading on the mat gets the dust collector working and only sucks the spot treaded.
- **Safety slope** : Preventing felling over and makes wheel chair and 대차 to pass conveniently.

2. How to install Air Max

-Install -

- 1) Set aside the place to install the machine near the entrance.
- 2) Install the No.① clean mat on the floor. The direction of the pipe is the spot where the dust collector is placed. So it is required to be the direction which is easy to connect the power.
- 3) Get the No. ② dust collector at the middle and connect the hose which is connected to the dust collector. After that, taping them to fix firmly.

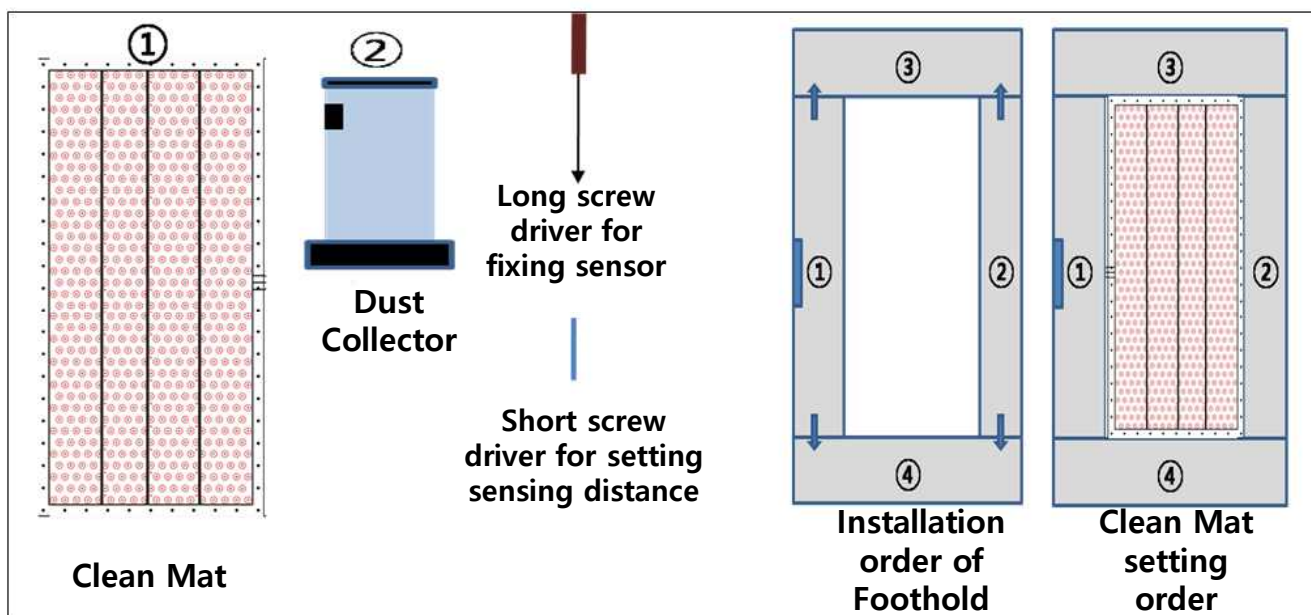

- Installation of vertical type dust collector -

- 1) Keep the dust collector in the correct position with the clean mat installed.
- 2) Connect the power to the outlet.
- 3) Turn on the power switch on the dust collector top panel.
- 4) Set the direction of the sensing sensor and adjust the sensing distance.

① First, lock the sensor in the inside direction to prevent the sensor from being detected.

- Insert the thin and long sensor driver deeply into the small hole in the corner of the top plate on the inner sensor,

Turn it to the left to release the sensor a little.

- Push the loosened sensor all the way to the right by hand to remove the small rubber packing next to the sensor and turn it fully counterclockwise with the small sensor adjustment screwdriver to prevent the sensor from being detected.
 - Check if sensor notices your hand. If not, sensor adjustment is clear. Put the long screwdriver into the hole on the top of the dust collector again, and then screw it tightly.
- ② Before adjusting the sensor, check the direction and the distance of it.
- If the distance of the sensor is too far or too close, put the long screw driver into the hole on the top of the dust collector and loosen it.
 - Push the loose sensor to the right and then take the rubber packing on the left side of sensor out. Adjust the distance of the sensor by turning the screw to the left or right. (Left to make it closer, Right to make it further.)
 - After the sensor adjustment, put the long screwdriver into the hole again. And then tighten the screw firmly.

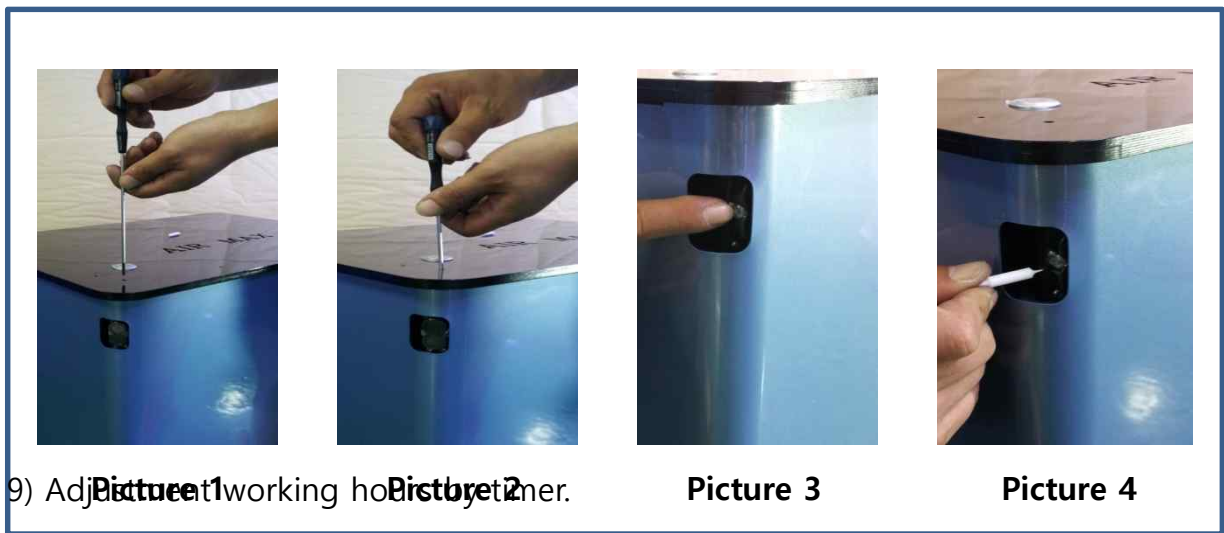

How to adjust the sensor

- Installation of horizontal type dust collector –

- 1) Use a double-sided tape to attach the foot sensor to the mat and place the dust collector in the correct position with the clean mat installed.
- 2) Connect the foot sensor to the dust collector and connect the power to the outlet..
- 4) Turn on the power switch on the bottom side of the dust collector
- 5) Adjust the sensitivity of the foot sensor by adjusting the flatness when the floor is unven

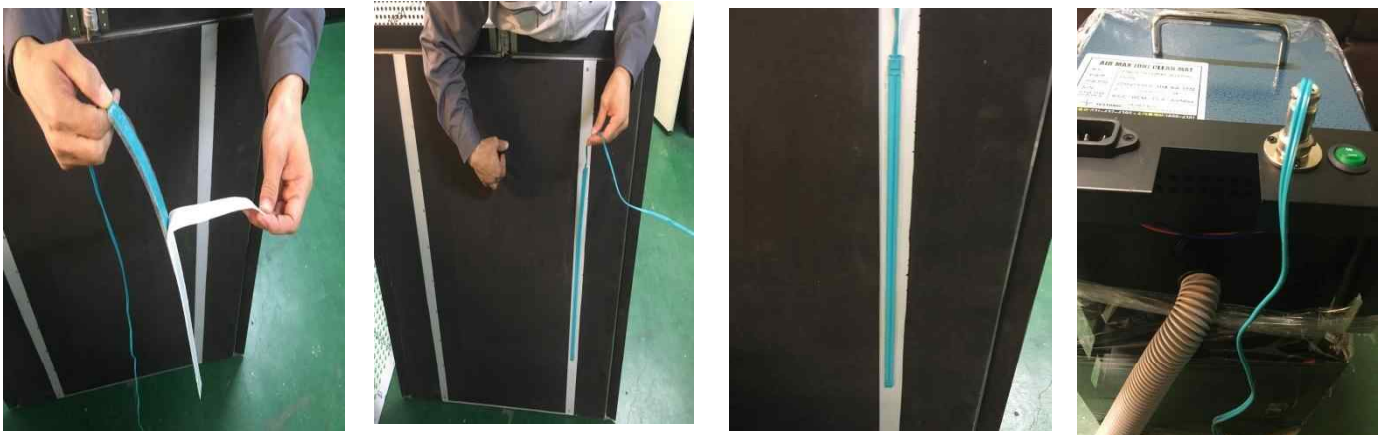

5) Adjust the operation time with timer.

• **-Hanyoung Timer**

• Timer is working in seconds. Open the back cover of precipitator, timer placed in the top of precipitator, turn the timer by hand to adjust the time. (The default setting is 3-4 seconds)

• **- Digital type Timer**

• Timer is working in seconds. Open the back cover of precipitator, timer placed in the top of precipitator, follow the steps to set the time. (The default setting is 3-4 seconds)

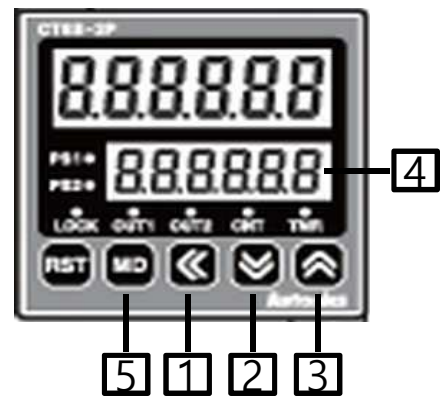

- ① If button 1 is pressed, area 4 will blink. Press button 1 to select the desired number of embroidery
- ② Press button 2 or 3 to decrease or increase the number.
- ③ After setting, press the button 5(Save)
- ④ Check if Airmax is working well.(Installation completed in normal operation)

3. How to replace **consumable stores**.

1) Replacement of the dust bag

When taking the dust bag out:

First, open the cover at the back of the dust collector. It has a dust bag like a usual vacuum cleaner. It can be removed by pushing up the support fixture. The dust bag connected with the hose should be downside not to get the dust out.

When replacing the dust bag:

On the contrary of getting rid of the dust bag, you should put the one dust bag first to the fixed support fixture and put into the hose in accordance with the hole for the dust bag. After that, put it by pushing it up the other support fixture and put it down to lock it.

- Replacement of dust bag period : 1 – 2Months



2) How to replace HEPA filter outlet

It is attached at the back of the dust collector. First, loosen the piss and get the used filter out. After that, put the new one. Following that, rinse off the filter net and get it dried to attach again.

- Replacement of HEPA filter period: 6– 7 Months
(Check and replace depending on the amount of the usage)



HEPA filter

4. Matters that require attention

- 1) This product is 220V Single phase current.
- 2) Do not use the product with wet hand.
- 3) When you use cleaning mat outdoor, it should be protected from rain and snow.
- 4) Suctioning power can be diminished if the dust bag is full.
- 5) The control box should be installed indoor.
- 6) Do not shock too much on the machine.
- 7) Stay away from the inflammables.
- 8) Do not control it by yourself even if it doesn't work and call the customer center right away.
- 9) Completely understand the instruction and always keep it.
- 10) Replace the filter on a regular basis.

5. How to handle the machine when it doesn't work?

Situation	Cause	Advice
Power is not working on	The plug is not connected	Connect the plug
	The power switch is off	Turn on the power switch
Monitor doesn't work	The sensor is broken	Check the sensor light
	Fuse is cut off	Replace the fuse
	Timer working lamp doesn't work.	Replace the timer
	The monitor is broken	Replace the monitor
Monitor keeps working	The light of the sensor doesn't turn off	Replace the sensor
	Timer power light doesn't flicker	Replace the timer
Suctioning power diminished dramatically	When the dust bag is full	Replace the dust bag
	Hose is broken or blocked	Replace the hose
Sensor doesn't work	Sensor light doesn't work even when it gets something	Replace the sensor

6. Product Specification

Main Function	Removing fine dust and harmful substances.
Operation Method	Suction type
Control Mode	Sensor, Timer
Filtering Equipment	Primary filter: Dust bag Secondary filter: HEPA filter (0.0003mm)
Rated Voltage	220V 50/60Hz(A single phase)
Power Consumption	400W Below
Mat sizes	<ul style="list-style-type: none"> ① 500 X 500 X 20(mm) ② 500 X 1000 X 20(mm) ③ 700 X 600 X 20(mm) ④ 700 X 1000 X 20(mm) ⑤ 500 X 2000 X 20(mm) ⑥ 1000 X 1000 X 20(mm) 
Dust Collector Size	250 X 350 X 560 (H)
Weight	Mat : 50Kg(1000x1000) / Dust collector : 15Kg

7. Air Max Checklist

	Item	Regular inspection interval	Check point	Condition	Remarks
1	Mat	Once a month	Brush condition	Naked eye	
2			Cleanliness state	Naked eye	
3			Spring condition	operation	
4			Inhale condition	anemometer	
5	Control Box	Once a month	Dust bag	Replace	
6			Functional condition	Naked eye	
7			Sensor condition	Naked eye	
8			Working temperature	thermometer	
9			Hose condition	Naked eye	
10			Noise	Acoustimeter	
11			HEPA filter	1 Year	Replace
12	24V power	TESTER			